

Selected Fan  
n Max

**NTHZ 355 B**  
**3150 1/min**

Fan working conditions  
Pw Max

**Free Inlet - Free Outlet**  
**6.50 kW**

**Certificates**

The AMCA licensed air performance data has been modified for installation type A: Free inlet - Free outlet not included in the certified data. The modified performance is not AMCA licensed but is provided to aid in selection and application of the product.

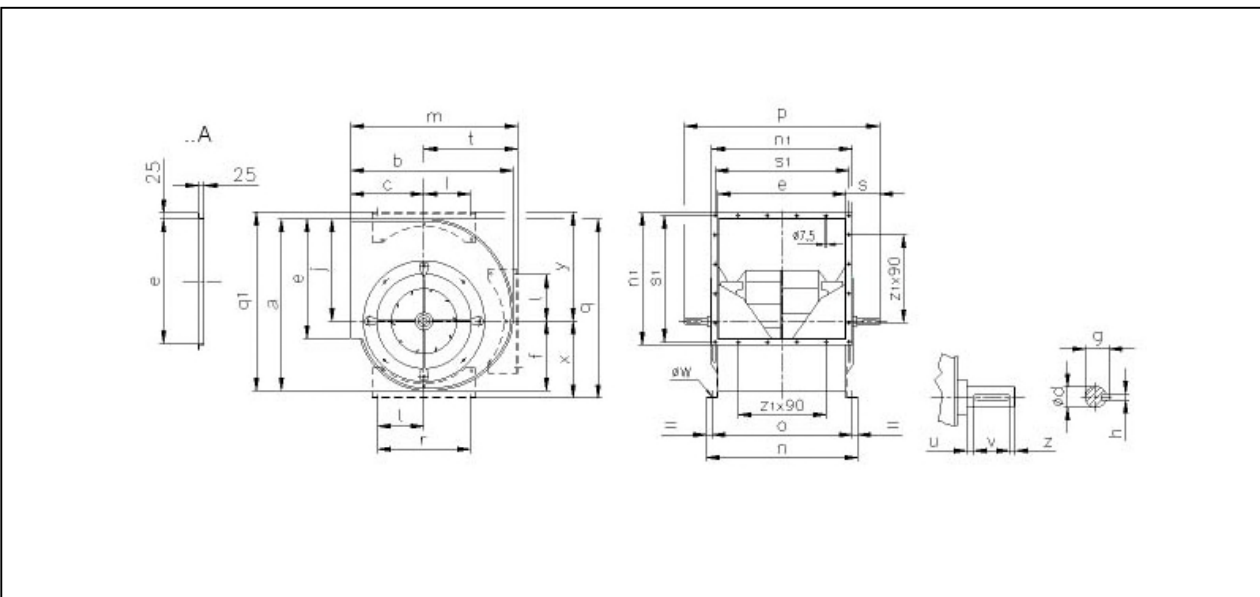
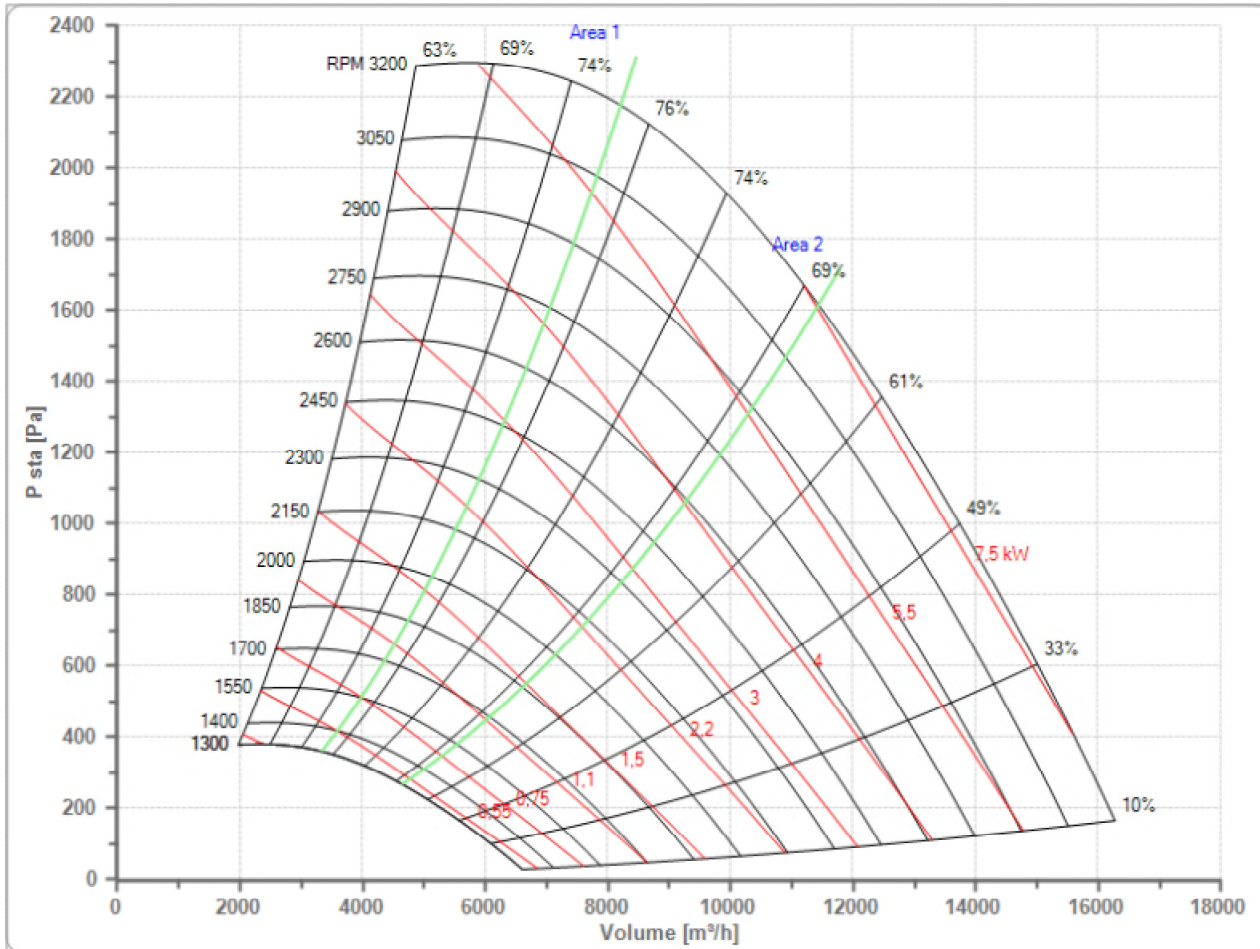

|     |     |     |     |      |     |     |     |       |     |
|-----|-----|-----|-----|------|-----|-----|-----|-------|-----|
| a   | b   | c   | e   | f    | g   | h   | j   | l     | m   |
| 646 | 576 | 261 | 453 | 262  | 33  | 8   | 384 | 177.5 | 581 |
| n   | n1  | o   | ød  | øw   | p   | q   | q1  | r     | s   |
| 533 | 503 | 493 | 30  | 10.5 | 655 | 657 | 672 | 355   | 101 |
| s1  | t   | u   | v   | x    | y   | z   | z1  |       |     |
| 483 | 319 | 7   | 40  | 273  | 410 | 10  | 4   |       |     |