

Selected Fan
n Max

TLZ 500 T
1300 1/min

Fan working conditions
Pw Max

Free Inlet - Free Outlet
11.00 kW

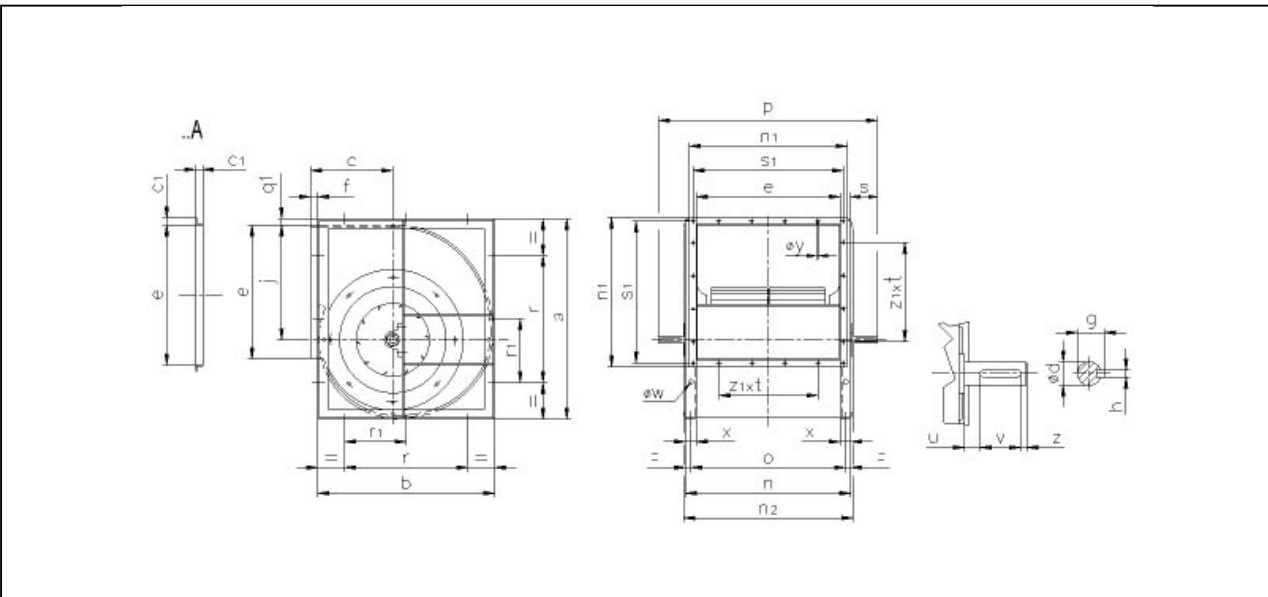
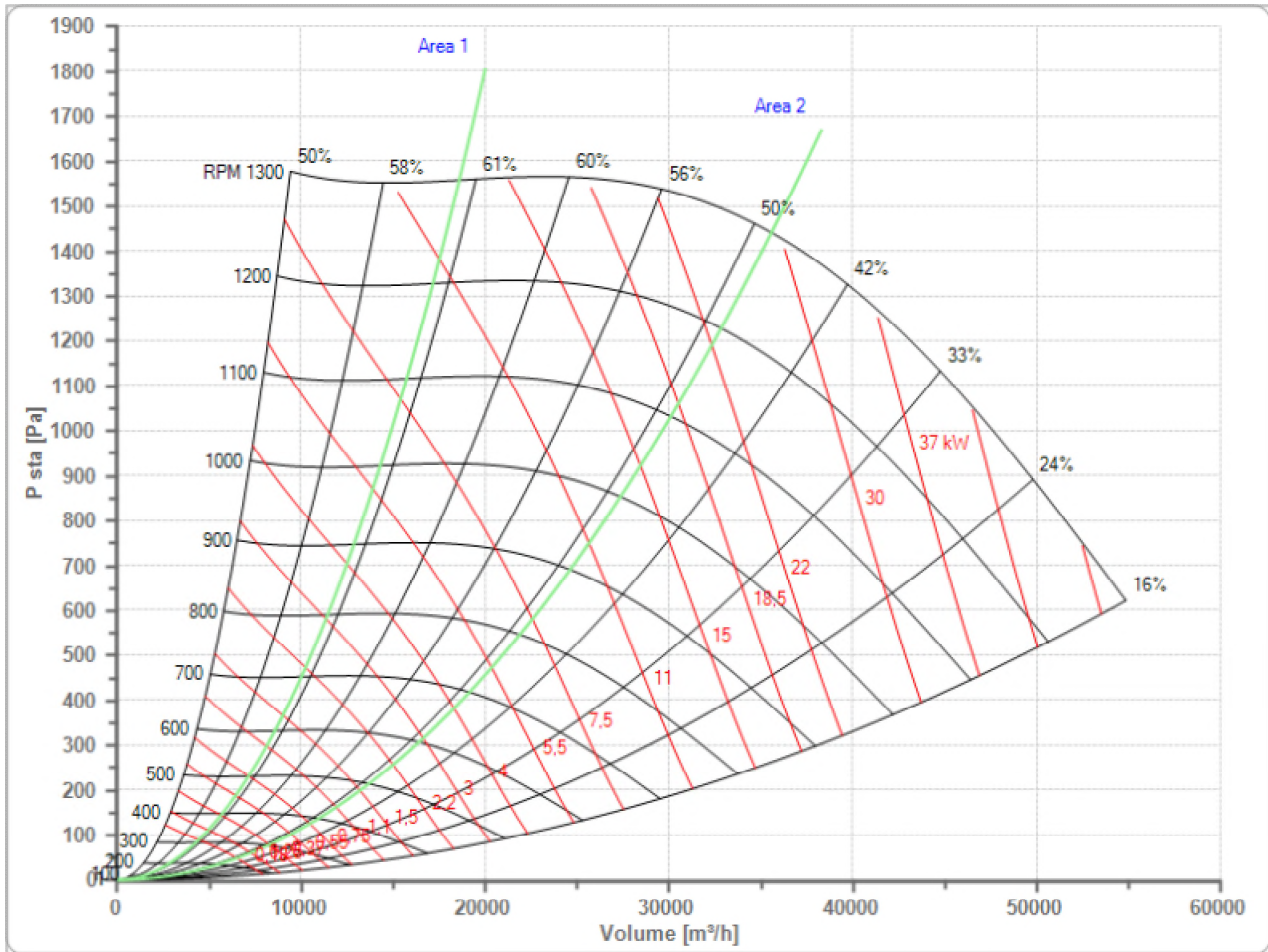

a	b	c	c1	e	f	g	h	j	n
918	744	352	25	638	56	38	10	540	718
n1	n2	o	ød	øw	øy	p	q1	r	r1
688	746	678	35	12	7.5	906	4	450	225
s	s1	u	v	x	z	z1xt			
94	668	16	50	40	10	6x90			